

ERICO, Inc.

34600 Solon Road • Solon, Ohio 44139
 Ph: 800-248-2677 • Fax: 800-462-4712

LENTON® FORM SAVER

Regional Manufacturing Fax Form

Date _____

PLEASE CHECK: ORDER RFQ

Page ___ of ___

Company Name _____

City, State, Zip _____

Contact Name _____

Phone # _____

Fax # _____

Project Name _____

SHIP TO:

Company Name _____

Address _____

City, State, Zip _____

Contact Name _____

Jobsite Phone # _____

Est. Date Required _____

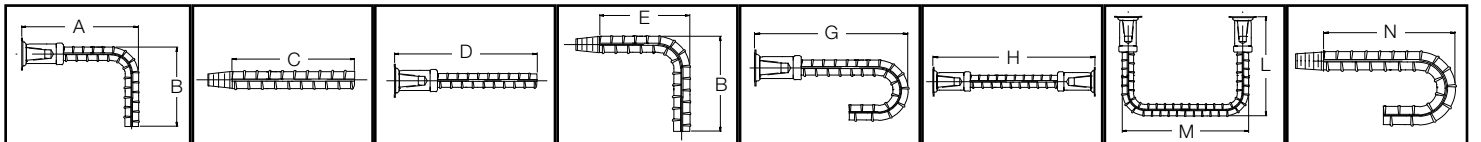

QTY	Size	E OR B	"A"	"B"	"C"	"D"	" "	" "	Mark	Wt#	Female \$	Male \$	Spcl. \$	Total \$
			Feet-Inches	Feet-Inches	Feet-Inches	Feet-Inches	Feet-Inches	Feet-Inches						
1			-	-	-	-	-	-						
2			-	-	-	-	-	-						
3			-	-	-	-	-	-						
4			-	-	-	-	-	-						
5			-	-	-	-	-	-						
6			-	-	-	-	-	-						
7			-	-	-	-	-	-						
8			-	-	-	-	-	-						
9			-	-	-	-	-	-						
10			-	-	-	-	-	-						
TOTAL WEIGHT											#'s	TOTAL \$		

Estimated Lead Time @ _____

Estimated Freight \$ _____

Comments: _____

QUOTED BY: _____

Copyright ©2003 ERICO International Corporation. All rights reserved.
 CADDY, CADWELD, CRITEC, ERICO, ERIFLEX, ERITECH, and LENTON are registered trademarks of ERICO International Corporation.

LENTON FORM SAVERS are recognized under ICBO ER Report 3967 for both Type 1 and Type 2 mechanical splice requirements for ASTM A615 GR60 reinforcing steel. LENTON, when installed in accordance with manufacturer's recommendations, has been evaluated to exceed the requirements of ACI 318-02 and IBC 2003.

The Regional Manufacturing Center is a contracted Manufacturing Center for ERICO, Inc. Solon, OH.

